

ELEVATION.

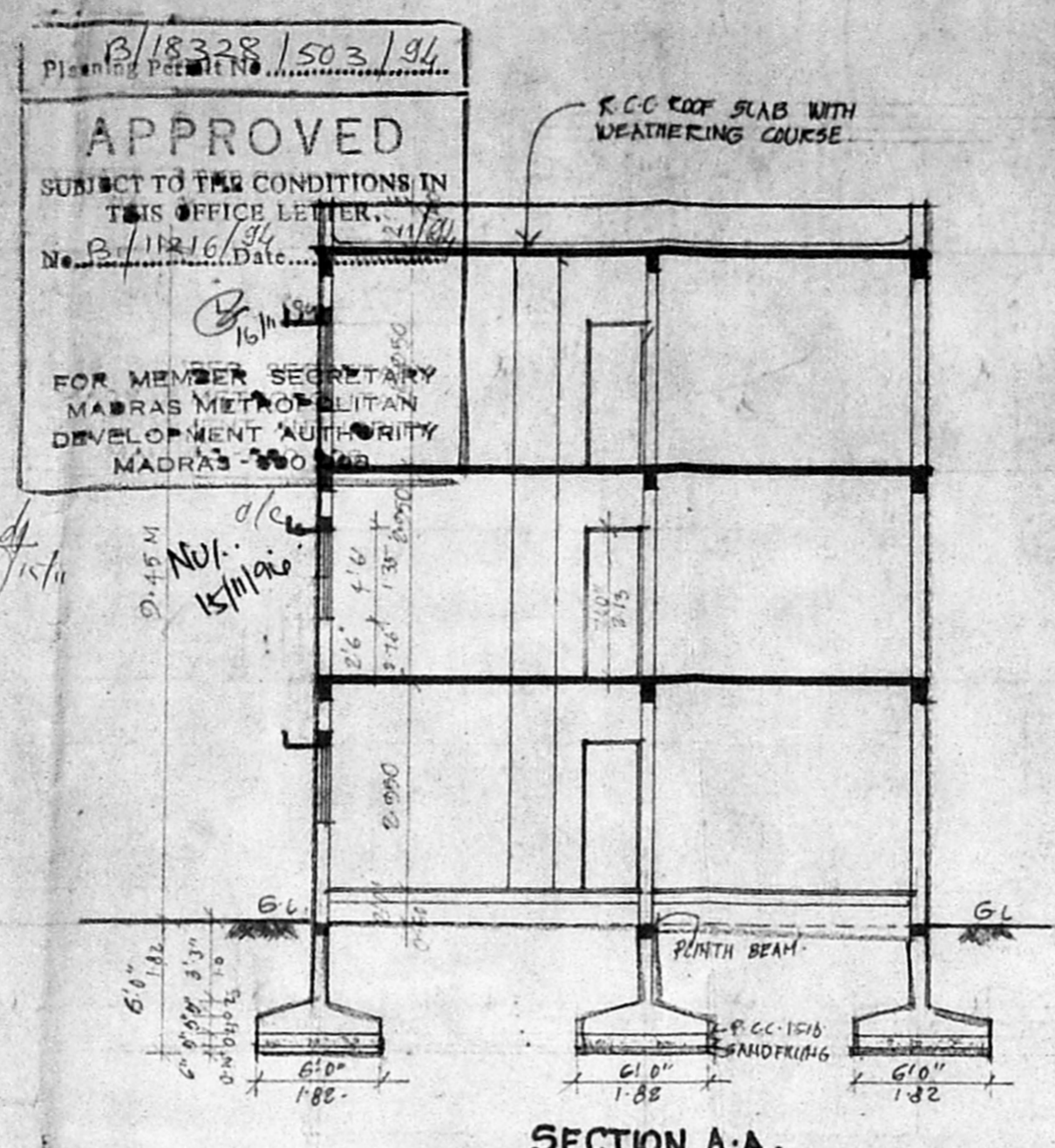

SECTION A-A.

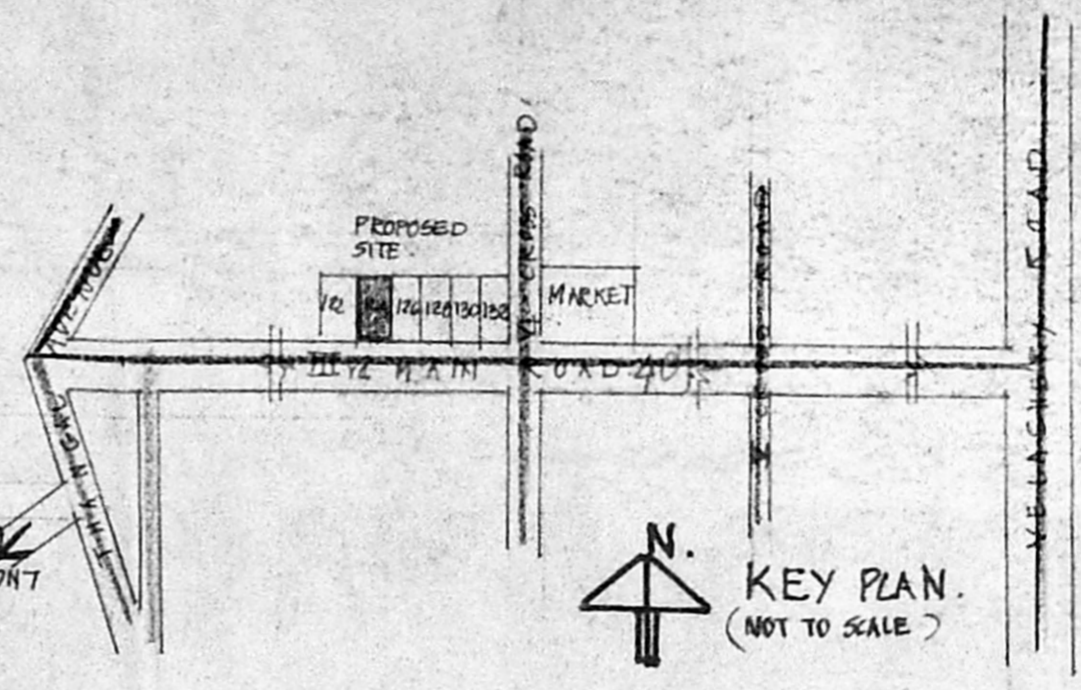

**SPECIFICATIONS**  
P.C.C. 1:5:10 FOR FOUNDATION & DRAINAGE.  
ALL BRICK WORKING IN CM 1:5 USING METRIC BRICKS.  
PLASTERING WITH CM 1:5 FOR WALLS & FOR CEILING.  
ALL R.C.C. WORKS SUCH AS BEAMS, COL. SLABS ETC. IN CC 1:2:4 MIX. USING 20 MM GRADE FLOORING WITH MOHAR TILES IN CM 1:5 WEATHERING COURSE OVER R.C.C. SLAB WITH LIME CONCRETE LAID TO SLOPE.  
ALL WOOD WORK WITH SEASONED TEAK WOOD.  
EXTERNAL FINISH WITH ONE COAT OF PRIMER OVER 3 COATS OF FINISH PAINT.

**SCHEDULE**

D	T.W. DOOR	3'0" X 7'0"	0.90 X 2.10
D1	T.W. DOOR	2'6" X 7'6"	0.76 X 2.10
N	T.W. GL. WINDOW	8'0" X 4'6"	2.44 X 1.30
N1	T.W. GL. WINDOW	5'0" X 4'6"	1.52 X 1.30
W2	T.W. GL. WINDOW	2'0" X 3'0"	0.61 X 0.91
D/W	DOOR/WINDOW	2'6" X 7'0"	0.76 X 2.13
V	T.W. VENTILATOR	2'6" X 2'0"	0.76 X 0.61

**AREA STATEMENT**

AREA OF PLOT	4770	54.31
IN GROUND FLOOR	1986.50	184.54
IN FIRST FLOOR	1986.50	184.54
IN SECOND FLOOR	1986.50	184.54
TOTAL	5959.50	553.63

FAIR = 1.249  
PLOT COVERAGE = 41.64%  
CAR PARKING NIL AS AREA OF ALL FLATS ARE LESS THAN 100M<sup>2</sup>

**PROPOSED FLATS AT**  
PLOT No: 124, 9-NO-101,  
SATHASIVA NAGAR, MADIPPAKKAM  
MADRAS FOR MRS. S. SUSEELAVASAN.

**NOTES.**  
PROPOSED: [Symbol]  
ROAD: [Symbol]  
BOUNDARY: [Symbol]

SCALE: 1:800 (1:100) DATE:

S. Susela Vasam  
OWNER / POWER OF ATTORNEY

S. ATHAYAN B.E.  
M19151, J<sup>RD</sup> AVENUE  
THIRUVALLUVAR NAGAR  
THIRUVANMIYUR  
MADRAS  
LICENSED SURVEYOR

